

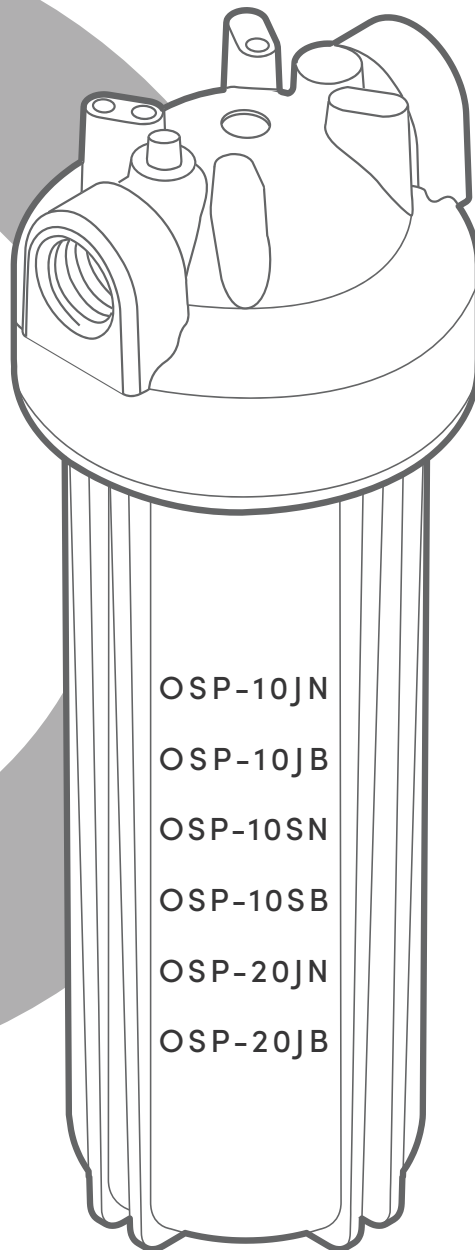

OneStop⁺™

Installation & Operating Instructions

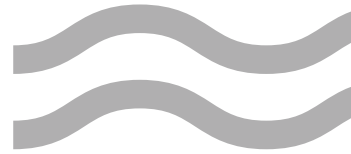

Chemical-free, salt-free,
scale prevention, and
heavy metals reducer



INTRODUCTION AND NOTES

OneStop+™ ANTI-SCALE SYSTEM

INTRODUCTION

The OneStop+ system protects from scale formation on internal and external plumbing surfaces. Additionally, it reduces heavy metals such as copper, lead, mercury, zinc, and cadmium. It should be installed at the point of use to treat water directly before a sink, an appliance, shower, or other water using device that requires protection from hard water.

OneStop+ prevents scale by transforming the normal dissolved hardness minerals into undissolved crystal microparticles. These crystals stay suspended in the water and have a greatly reduced ability to react and attach to surfaces as dissolved hardness does. Therefore the problem of internal build-up of scale in pipes, water heaters, boilers, espresso and coffee machines, fixtures, and glass is greatly reduced.

OneStop+ is not a water softener – water treatment chemistry (e.g. antiscalants, sequestrants, etc.) will most likely have to be changed to be compatible with OneStop+ treated water. Laundry and warewashing chemistry will likewise require adjustments.

OneStop+ BENEFITS

- Chemical-free scale prevention. Cost savings and environmentally friendly benefits.
- Simple installation and virtually maintenance-free.
- No electricity, no salt, no regeneration or backwash, no wastewater, completely self-contained.
- Improves the efficiency of boilers and other water-using appliances.
- Reduces heavy metals such as copper, lead, mercury, zinc, and cadmium.
- Reduces existing limescale deposits.
- Compatible with all on-site and community wastewater treatment systems.
- Not subject to water softener restrictions and “bans”.
- OneStop+ retains essential minerals. Its treated water has no added sodium, is safe to drink, and is well suited for use in food and beverage preparation.

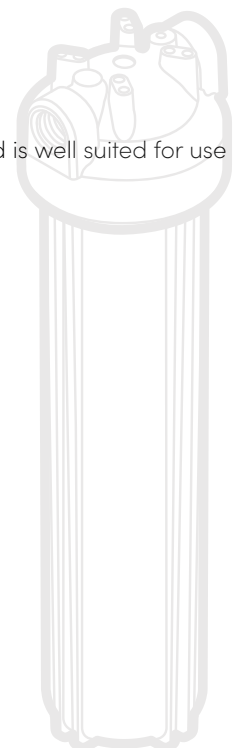
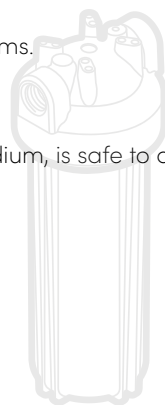
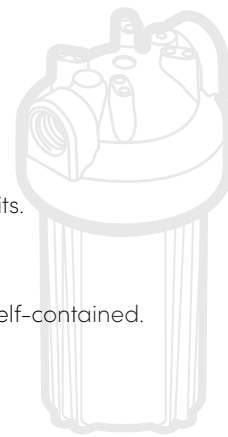

Using a OneStop+ system with other water treatment equipment

Due to the unique properties of OneStop+, there are some unique requirements for using OneStop+ in conjunction with filtration or other forms of water treatment.

1. OneStop+ must be the last stage in the treatment chain. Do not install filters after OneStop+ or before any devices for which scale prevention is required. POU filters, e.g., carbon or RO, are exempt from this requirement.
2. Do not apply phosphate or any other antiscalant before or after OneStop+.

An important note about iron and manganese in the water supply

Iron and Manganese

Like conventional water softening media, OneStop+ needs to be protected from excess levels of certain metals that can easily coat the active surface, reducing its effectiveness over time. Public water supplies rarely, if ever, present a problem, but if the water supply is from a private well, confirm that the levels of iron (Fe) and manganese (Mn) are less than 0.3 ppm and 0.05 ppm respectively. If water quality is unknown, a water analysis is advisable to understand the water chemistry.

Cautions

- Do not let the system freeze. Damage to the tank may result.
- System must be operated in a vertical position. Do not lay it down during operation. The system may be placed horizontally for shipping and installation but must be operated in the vertical position.
- Install the system so that it is level, because level surface because the system operates in an upflow, fluidized bed mode, having a level surface is more important than with a softener or media filter.
- A bypass valve should be installed on every system to facilitate installation and service.
- Observe all local plumbing and building codes when installing the system.

Notes to the installer

The OneStop+ system differs from a conventional softener or media filter in a number of key respects.

- The cartridge is light and only partially filled with media, this is normal. The upflow operation of the system requires a lot of freeboard to allow the bed to fully fluidize.
- Please see the "an important note about iron and manganese in the water supply".
- Please see the note about "Using OneStop+ with other water treatment equipment".



TECHNICAL DATA AND COMPONENTS

OneStop+™ ANTI-SCALE SYSTEM

EQUIPMENT SPECIFICATIONS

OneStop+ systems are complete, self-contained, loaded with media and ready to use. A simple inlet and outlet connection is all that is required for installation. Please review operating pressures, temperatures and water chemistry limitations to ensure compatibility.

Water Chemistry Limits

pH	6.5 ~ 8.5
Temperature	4° ~ 40°C / 40° ~ 104°F
Hardness (Maximum)	1300 ppm
Ferrous Iron, Max*	0.3 ppm
Manganese, Max*	0.05 ppm
Chlorine, Max*	< 3 ppm
Calcium Sulphate (CaSO ₄)	> 300 ppm treat before OneStop+
Phosphate (PO ₄)	< 0.3 ppm: Activated carbon prefiltration recommended > 0.3 ppm: Activated carbon prefiltration required
Oil & Polyphosphates	Treat before OneStop+
Hydrogen Sulfide	Treat before OneStop+

Model		OSP-10SB OSP-10SN	OSP-10JB OSP-10JN	OSP-20JB OSP-20JN
Connection		3/4" BSPP / NPT	3/4" BSPP / NPT	3/4" BSPP / NPT
Rated Service Flow	lpm	3	8	15
	gpm	0.8	2	4
Intermittent Peak Flow	lpm	5	12	22
	gpm	1.3	3.2	5.8
Dimensions (mm)	A	326	356	621
	B	115	183	183
Dry Weight (kg)		1.4	4.5	6.3
Min. Temperature		4°C / 40°F	4°C / 40°F	4°C / 40°F
Max. Temperature		40°C / 104°F	40°C / 104°F	40°C / 104°F
Max. Pressure		125 psi 8.6 bar	125 psi 8.6 bar	125 psi 8.6 bar
Replacement Cartridge		OSP-10SR	OSP-10JR	OSP-20JR

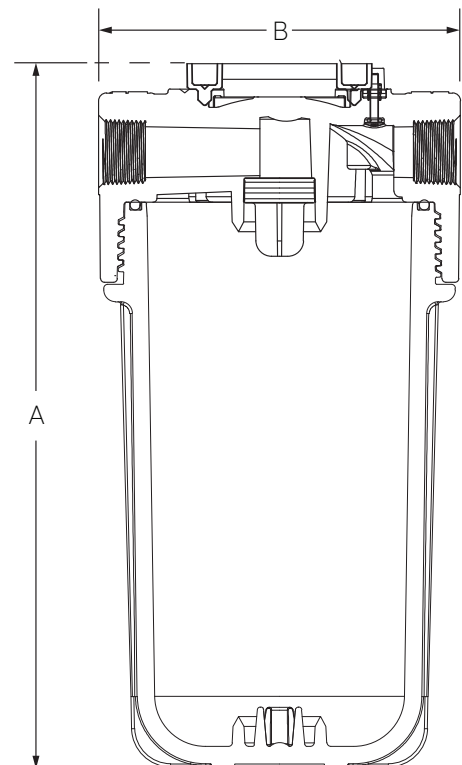

OneStop+ COMPONENTS

#1 OneStop+ Filter Housing

#2 OneStop+ Filter

- spanner
- bracket
- installation screw kit

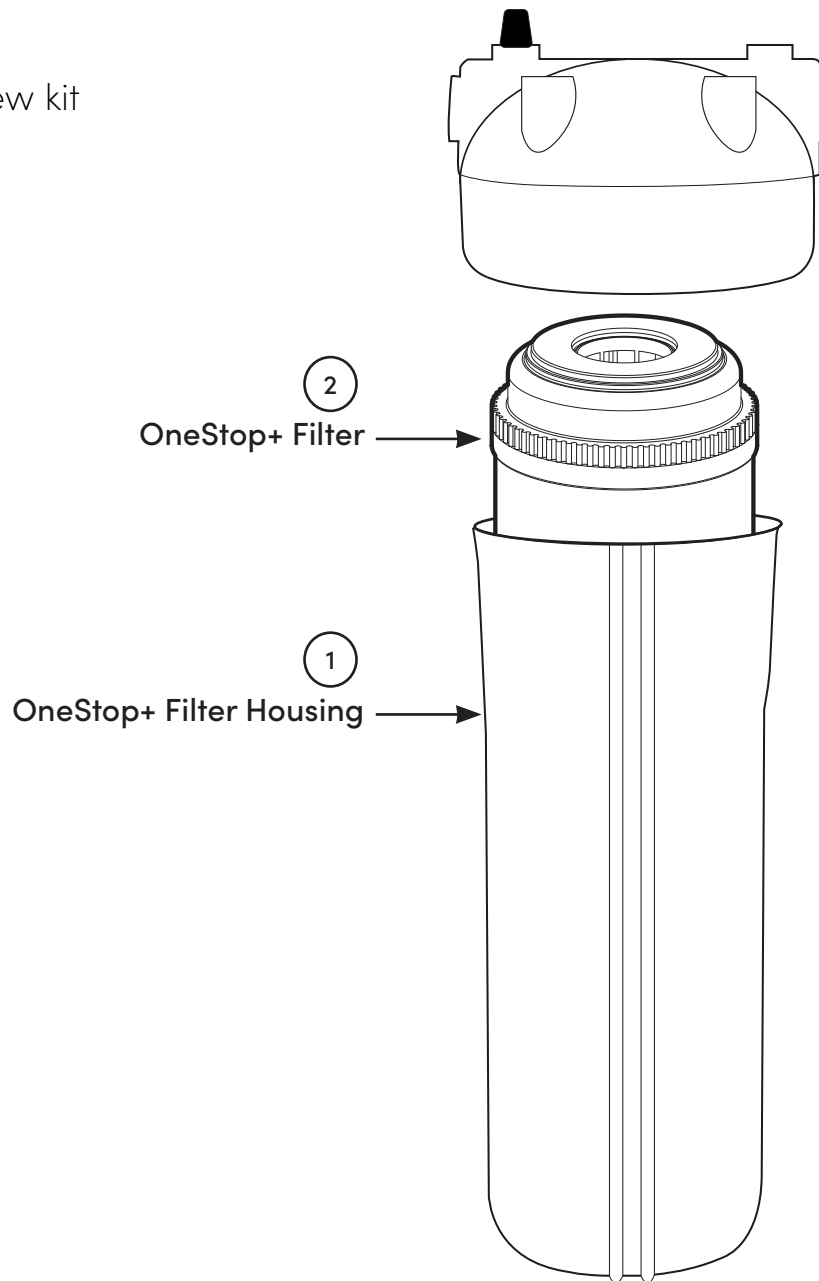



INSTALLATION MANUAL

OneStop+™ ANTI-SCALE SYSTEM

INSTALLATION INSTRUCTIONS

The systems will be shipped with the OneStop+ filter installed inside the housing.

1. Place the system in the desired location. (See Fig.1)

Fig. 1.1

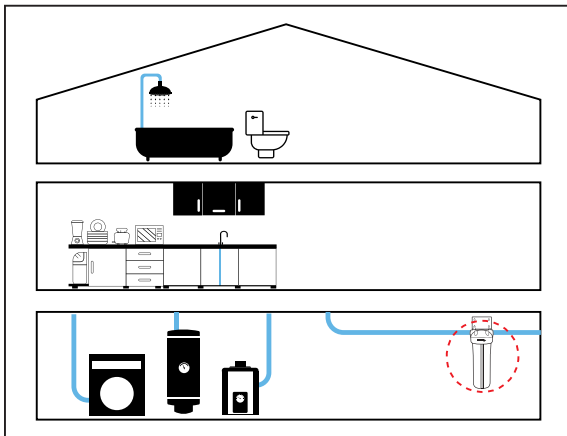

Fig. 1.2 - Bracket Installation

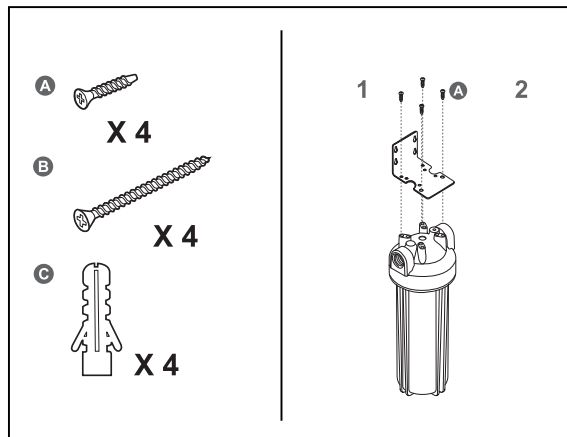
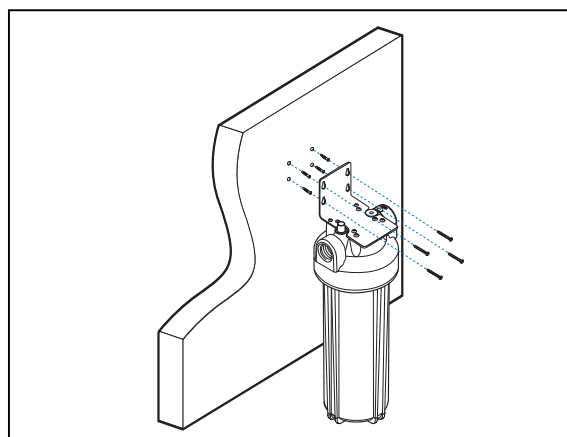
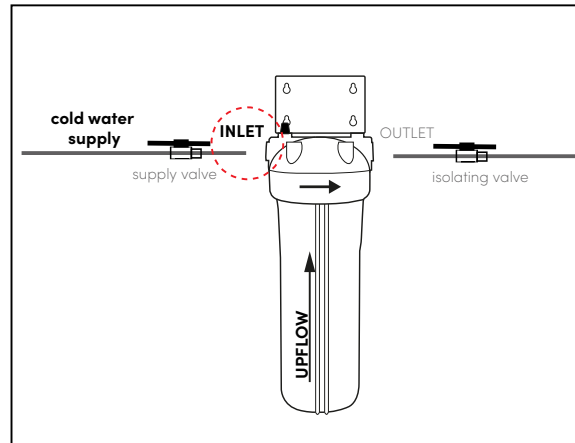

Fig. 1.3 - Bracket Installation



2. Connect the cold water supply to the inlet of the OneStop+ system. (See Fig.2)

Fig. 2



3. Connect the outlet of the OneStop+ system to the cold water supply to the home/point of use. (See Fig. 3)

Fig. 3

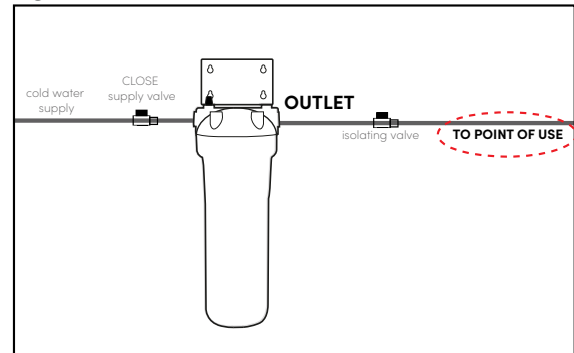

4. Open the supply valve/isolating valve to the OneStop+ system.

Fig. 4

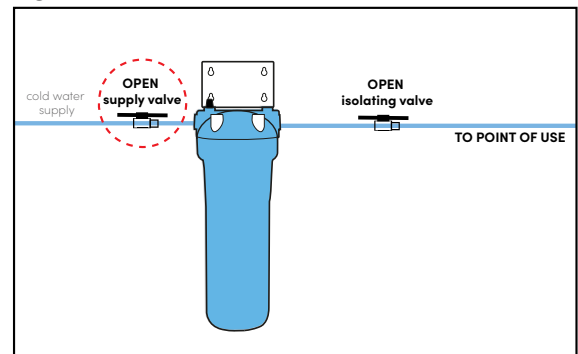

INSTALLATION INSTRUCTIONS

5. Check for leaks. Repair as needed.

Fig. 5

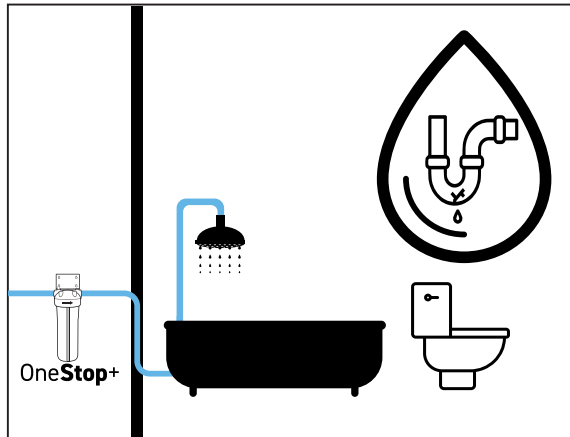

6. The system is now ready for use.

Fig. 6

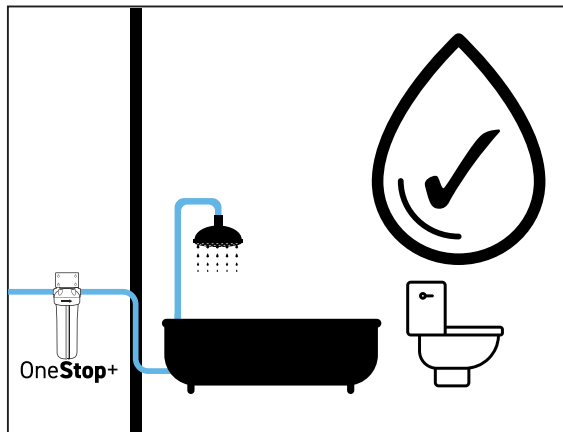



INSTALLATION MANUAL

OneStop+™ ANTI-SCALE SYSTEM

A NOTE TO THE HOME OWNER

Your OneStop+ system will improve the properties of water throughout your home. Here are some things to expect and some recommendations for maximizing the benefits and your enjoyment of OneStop+.

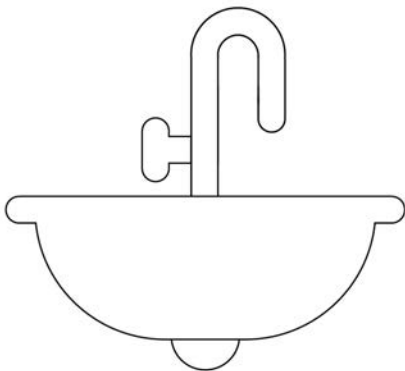

Sinks and fixtures - reduced spotting. If water is allowed to evaporate off a surface, small spots may be left behind. If wiped off frequently, the spotting should not require any more than a wet cloth or sponge to remove. No harsh chemical should be required as with typical hard water spotting.

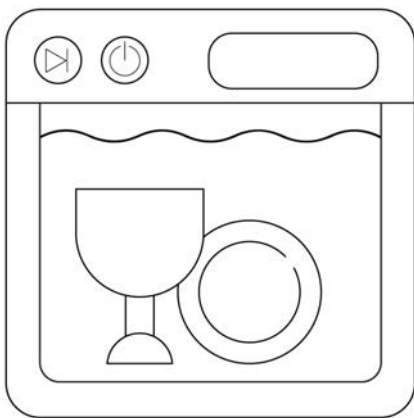

Dishwasher - Spotting on dishes and on the surface of the dishwasher should be greatly reduced. We recommend that you immediately reduce the amount of dishwashing detergent by approximately 50% as compared to hard water use. Dishwashing detergents low in phosphates are highly recommended as they are better for the environment and phosphates can cause spotting. The use of a rinse aid may be advised.

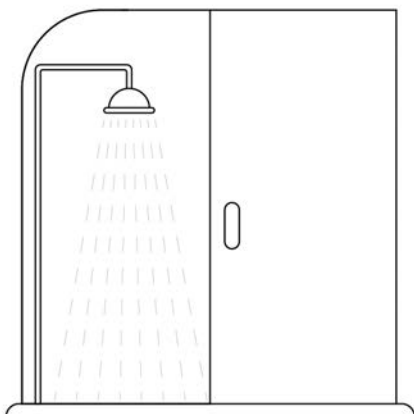

Shower doors and tiles - should have reduced spotting. When water evaporates off a surface, small spots may be left behind. These spots should be easy to remove with a damp cloth or sponge. In very hard water areas treating the shower glass with Rain-X 2 in 1 glass cleaner, or equivalent, will further reduce cleaning requirements.

In the bath you should notice that soaps and shampoos lather more than with untreated water. Soaps and shampoos will also rinse off much easier and faster than they would with traditional soft water. We recommend the use of modern soaps for the best results.

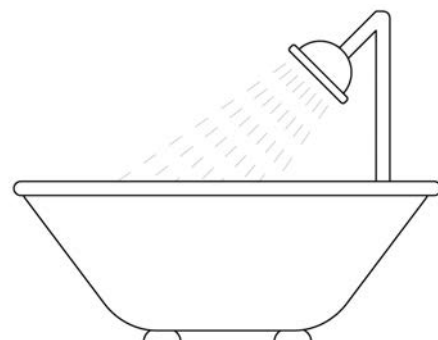

LIMITED WARRANTY

Global Water Solutions warrants the OneStop+ system as follows:

- The housing is warranted to be free of defects in materials and workmanship for 1 year from the date of original installation.
- The OneStop+ media is warranted for performance for a period of 2 years from the date of the original installation.

Conditions

1. The OneStop+ system must be installed and serviced by an authorized Global Water Solutions dealer, or other entity approved by Global Water Solutions.
2. Any component failure must not result from abuse, fire, freezing or other acts of nature, violence, or improper installation.
3. Equipment must be installed and operated in compliance with the local plumbing codes, and on an approved water supply.
4. Equipment is limited to use at water pressures not to exceed 8.6 bar | 125 psi and temperatures not to exceed 40°C / 104°F.
5. Water supply must not exceed 3.0 ppm chlorine. For water supply exceeding 3.0 ppm chlorine, pretreatment is required. (Please contact your water treatment specialist.)
6. Information, including model number, serial number, and date of installation, must be provided for any claims pertaining to equipment in warranty.
7. Defective parts are subject to inspection by either Global Water Solutions or any authorized representative before final commitment of warranty adjustment is made.
8. Global Water Solutions reserves the right to make changes or substitutions in parts or equipment with material of equal quality or value and of then current production.

Limitations

Our obligation under this warranty with respect to the housing and cartridge is limited to furnishing a replacement for, or at our option, repairing any part or parts to our satisfaction that prove defective within the warranty period stated above. Such replacement parts will be delivered to the owner F.O.B. nearest factory, at no cost, excluding freight and local labor charges, if any. Our obligation under this warranty with respect to the OneStop+ media will be limited to furnishing a replacement for the media within two years from date of original installation. Such replacement media will be delivered to the owner F.O.B. nearest factory, at no cost, excluding freight and local labor charges, if any. Damage to the media due to chlorine, other oxidizers or fouling or any other operation outside of the limits shown under Specifications, is not covered by this warranty. Global Water Solutions shall not be liable for freight, handling or labor charges, or consequential damages.



Have questions or need assistance?

www.globalwatersolutions.com